

**Accessible Toilets.**

The old toilet and boiler room will become our new accessible toilet facilities with an entry door directly from inside the church.

**Upholstered chairs.**

The existing pews will be replaced with good quality, lightweight, stackable, upholstered wooden chairs. These will be placed in different configurations, as required, and will be supplemented by additional folding chairs when needed for large events.





**Two-step Dais.**

The dais will create a prominent raised area at the front of the Nave. This will improve visibility for Church services and for performance events.

**Organ, Vestry, Choir, Chancel and Sanctuary**

Apart from having better lighting, heating, storage and decoration the only change here will be the creation of a chancel chapel using some of the old pews from the Nave.

**Key**

- Carpeted area** 
- Timber boards** 
- Tiled gangways** 
- Radiator** 

**Choir Vestry & Multi-purpose room.**

The entrance area under the west tower will be converted into a room that can be used for teaching, meetings and for the choir vestry.

**Ringling chamber**

The arch between the Nave and the ringing chamber will be glazed for better integration of both bell-ringing and music (See View 1).

**Kitchen/servery.**

A small kitchen (with a hot-water boiler, fridge, oven and sink) and a servery will be added. With these facilities we can prepare and serve simple food in the Church – to support fellowship, mission activities and secular events.



**View 1. The Nave from the Dais**

**Improved entrances**

The inner south doors (and west doors) will be modified and glazed to create more welcoming entrances that let more light into the Church.



**View 2. The Nave from the south-east corner**

**Flooring.**

All the existing flooring (including the tiled gangways and timber boarding) will be preserved and repaired. Some areas will be carpeted (see Key). Overall, this will create a more welcoming environment which is sympathetic with the medieval architecture and more suitable for a wide range of uses including different worship styles and secular events.

**Plan of Church after Renewal  
showing key features of the Project**

Sept 2019

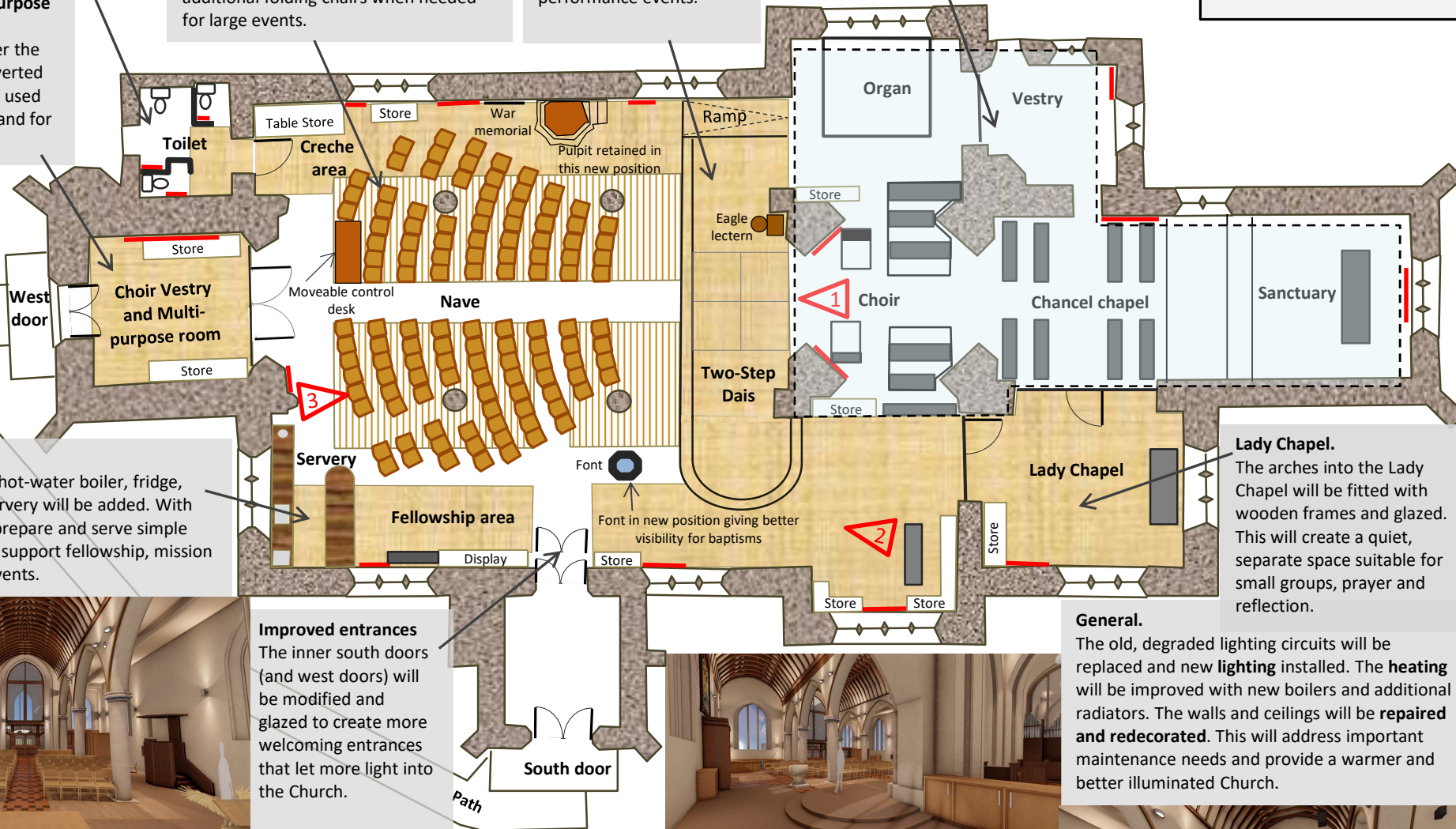

**General.**

The old, degraded lighting circuits will be replaced and new lighting installed. The heating will be improved with new boilers and additional radiators. The walls and ceilings will be repaired and redecorated. This will address important maintenance needs and provide a warmer and better illuminated Church.



**View 3. The Nave from the south-west corner**